

vtech[®]
Baby

User's Manual

Musical Rhymes Book



© 2015 VTech
Printed in China
91-002995-001 

VTech understands that a child's needs and abilities change as they grow and with that in mind we develop our toys to teach and entertain at just the right level...

vtech Baby

Toys that will stimulate their interest in different textures, sounds and colours

I am...

...responding to colours, sounds and textures

...understanding cause and effect

...learning to touch, reach, grasp, sit-up, crawl and toddle

Birth-36 months



Pre-School

Interactive toys to develop their imagination and encourage language development

I want...

...to get ready for school by starting to learn the alphabet and counting

...my learning to be as fun, easy and exciting as can be

...to show my creativity with drawing and music so my whole brain develops

3-6 years



Electronic Learning Computers

Cool, aspirational and inspiring computers for curriculum related learning

I need...

...challenging activities that can keep pace with my growing mind

...intelligent technology that adapts to my level of learning

...National Curriculum based content to support what I'm learning at school

4-10 years



To learn more about this and other VTech® products, visit www.vtech.co.uk

INTRODUCTION

Thank you for purchasing the **VTech® Musical Rhymes Book**.

Explore classic nursery rhymes with the **Musical Rhymes Book** by **VTech®**. Slide and twist the fun play pieces while exploring each easy-to-turn page. Then play piano sounds with the five colourful piano keys that introduce colours and instruments.

LIGHT-UP STAR

SLIDING BEAR



ON/OFF/
MODE SELECTOR SWITCH

INSTRUMENT BUTTONS

INCLUDED IN THIS PACKAGE

- One VTech® Musical Rhymes Book learning toy
- One user's manual

WARNING: All packing materials, such as tape, plastic sheets, wire ties and tags are not part of this toy and should be discarded for your child's safety.

Unlock the packaging locks:

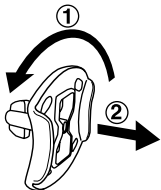

- ① Rotate the packaging locks 90 degrees counter-clockwise.
- ② Pull out the packaging locks.

NOTE: Please keep user's manual as it contains important information.

GETTING STARTED

BATTERY INSTALLATION

1. Make sure the unit is turned **OFF**.
2. Locate the battery cover on the top of the spine of the book. Use a screwdriver to loosen the screw.
3. Install 2 new AAA (AM-4/LR03) batteries following the diagram inside the battery box. (The use of new, alkaline batteries is recommended for maximum performance.)
4. Replace the battery cover and tighten the screw to secure.

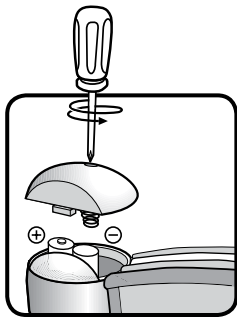

BATTERY NOTICE

- Use new alkaline batteries for maximum performance.
- Use only batteries of the same or equivalent type as recommended.
- Do not mix different types of batteries: alkaline, standard (carbon-zinc) or rechargeable (Ni-Cd, Ni-MH), or new and used batteries.
- Do not use damaged batteries.
- Insert batteries with the correct polarity.
- Do not short-circuit the battery terminals.
- Remove exhausted batteries from the toy.
- Remove batteries during long periods of non-use.
- Do not dispose of batteries in fire.
- Do not charge non-rechargeable batteries.
- Remove rechargeable batteries from the toy before charging (if removable).
- Rechargeable batteries are only to be charged under adult supervision.

Disposal of batteries and product



The crossed-out wheellie bin symbols on products and batteries, or on their respective packaging, indicates they must not be disposed of in domestic waste as they contain substances that can be damaging to the environment and human health.



The chemical symbols Hg, Cd or Pb, where marked, indicate that the battery contains more than the specified value of mercury (Hg), cadmium (Cd) or lead (Pb) set out in Battery Directive (2006/66/EC).

The solid bar indicates that the product was placed on the market after 13th August, 2005.

Help protect the environment by disposing of your product or batteries responsibly.



For more information, please visit:

www.recycle-more.co.uk

www.recyclenow.com



PRODUCT FEATURES

1. ON/OFF/MODE SELECTOR SWITCH

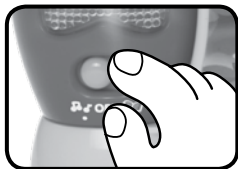
To turn the unit **ON**, slide the **ON/OFF/MODE SELECTOR SWITCH** to the **SING-ALONG MODE** () or the **MUSIC MODE** () position. To turn the unit **OFF**, slide the **ON/OFF/MODE SELECTOR SWITCH** to the **OFF** () position.



2. VOLUME CONTROL SWITCH

To adjust the volume, slide the **VOLUME CONTROL SWITCH** on the back of the unit to the **LOW VOLUME** () or the **HIGH VOLUME** () position.

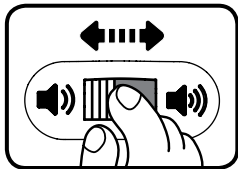

3. AUTOMATIC SHUT-OFF

To preserve battery life, the **VTech® Musical Rhymes Book** will automatically power-down after several seconds without input. The unit can be turned on again by pressing the instrument buttons or by turning the pages.

ACTIVITIES

1. Slide the **on/off/mode selector switch** to turn the unit on. You will hear a song and a playful phrase in the sing-along mode and a playful phrase and melody in the music mode. The light will flash with the sounds.
2. Turn the **book pages** in the sing-along mode to hear a fun sound and a sung nursery rhyme. In the music mode you will hear a fun sound and a melody. The light will flash with the sounds.
3. Press the **instrument buttons** in the sing-along mode to hear the colour of the button introduced, the instrument name and sound or a random melody played with the related instrument sound. In the music mode you will hear individual piano notes. The light will flash with the sounds.



MELODY LIST

1. A-Tisket, A-Tasket
2. Humpty Dumpty
3. Old MacDonald Had a Farm
4. Hey Diddle Diddle
5. Little Miss Muffet
6. Here We Go Round the Mulberry Bush

Sing-Along Song Lyrics

SONG 1

A-tisket, a-tasket.

A green and yellow basket,

I wrote a letter to my love

On the way I dropped it.

SONG 2

Humpty Dumpty sat on a wall,

Humpty Dumpty had a great fall,

All the king's horses and all the king's men,

Couldn't put Humpty together again.

SONG 3

Old MacDonald had a farm,

E-I-E-I-O.

And on his farm he had some pigs,

E-I-E-I-O.

With an oink oink here,

And an oink oink there,

Here an oink, there an oink,

Everywhere an oink oink,

Old MacDonald had a farm,

E-I-E-I-O.

SONG 4

Hey diddle diddle,

The cat and the fiddle,

The cow jumped over the moon.

The little dog laughed,

To see such fun,

And the dish ran away

With the spoon!

SONG 5

Little Miss Muffet,

Sat on a tuffet,

Eating her curds and whey.

Along came a spider,

Who sat down beside her,

And frightened Miss Muffet away!

SONG 6

Here we go round the mulberry bush,
The mulberry bush,
The mulberry bush.
Here we go round the mulberry bush,
On a cold and frosty morning.

CARE & MAINTENANCE

1. Keep the unit clean by wiping it with a slightly damp cloth.
2. Keep the unit out of direct sunlight and away from any direct heat source.
3. Remove the batteries when the unit is not in use for an extended period of time.
4. Do not drop the unit on hard surfaces and do not expose the unit to moisture or water.

TROUBLESHOOTING

If for some reason the program/activity stops working or malfunctions, please follow these steps:

1. Please turn the unit **OFF**.
2. Interrupt the power supply by removing the batteries.
3. Let the unit stand for a few minutes, then replace the batteries.
4. Turn the unit **ON**. The unit should now be ready to play again.
5. If the product still does not work, replace with a new set of batteries.

If the problem persists, please call our Consumer Services Department on 01235 546810 (from UK) or +44 1235 546810 (outside UK) and a service representative will be happy to help you.

IMPORTANT NOTE:

Creating and developing VTech products is accompanied by a responsibility that we take very seriously. We make every effort to ensure the accuracy of the information, which forms the value of our products. However, errors sometimes can occur. It is important for you to know that we stand behind our products and encourage you to call our Consumer Services Department on 01235 546810 (from UK) or +44 1235 546810 (outside UK), with any problems and/or suggestions that you might have. A service representative will be happy to help you.

**CLASS 1
LED PRODUCT**



PRODUCT WARRANTY



Thank you for choosing this quality product from VTech. We hope it will bring many hours of entertainment, imaginative play and learning.

1. The product detailed above is covered by a one year warranty from the date of purchase, against any defects in materials or workmanship.
2. The product may be returned to the place of purchase. Alternatively the product can be returned to VTech Electronics Europe plc (see address below), with proof of purchase, without proof of purchase no replacement will be provided.
3. VTech Electronics Europe plc will examine the product and if it is found to be defective due to faulty materials or workmanship, will replace the product at their discretion.
4. If the product covered by this warranty is damaged due to misuse, modification or unauthorised repair, or because of faulty batteries, battery discharge or incorrect electrical connections, then this warranty becomes void.
5. This warranty is personal to the original purchaser and is not transferable.
6. Breakages to the LCD screen are not covered by the warranty.
7. Returns to VTech Electronics Europe plc should include a cheque or postal order for £1.50 towards the cost of return postage and packaging.
8. Products returned to VTech Electronics Europe plc, should be addressed as follows and packed carefully to avoid damage in transit (Please do not include batteries or adaptor).
Please include details of the fault together with your name and address.

VTech Electronics Europe plc, c/o Tablogix Limited, 200 Milton Park, Abingdon, Oxon OX14 4TA

THIS WARRANTY IS OFFERED AS AN EXTRA BENEFIT AND DOES NOT AFFECT CONSUMERS' STATUTORY RIGHTS.

This warranty is valid for the UK and Eire only. For products purchased outside the UK and Eire, please contact your local distributor or place of purchase.

